

MOBISHEAR

A U S T R A L I A

100% CORDLESS

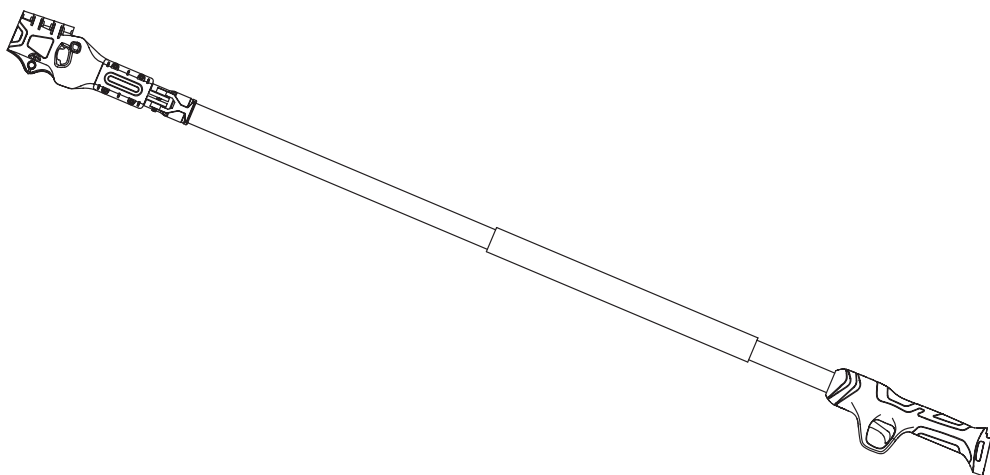

TELESCOPIC POLE FOR USE WITH MSP 3724-2.5 37MM CORDLESS SECATEUR

MSP 3724-2.5TP

INSTRUCTION MANUAL

Register your Telescopic Pole online at
www.mobishear.com.au for an extended warranty

CONTENTS

Introduction	4
Safety Warnings	4
Waste Disposal	4
Precautions Before Use	5
Safety Instructions for Worksites.....	5
Electrical Safety Instructions	5
Personal Safety Instructions.....	5
Telescopic Pole Operation.....	6
Installing MSP 3724-2.5.....	6
Telescopic Pole Length Adjustment	7
Parts List.....	8
Technical Data.....	10

INTRODUCTION

Mobishear is an Australian farming family owned business that was born from a need for innovation out in the paddock, but more importantly a desire to provide the best possible service. We have now moved out of the sheep yards and into the vineyard and orchard by offering you this telescopic extension pole to increase the versatility of your Mobishear 100% Cordless 37mm Secateur.

You can buy with confidence from us as we are a 100% Australian owned business here to provide you with full after-sales service.

Please read all safety warnings and instructions carefully. Failure to follow these warnings and instructions may result in electric shock, fire, severe burns or other serious injury.

PLEASE KEEP THESE INSTRUCTIONS FOR FUTURE REFERENCE.

SAFETY WARNINGS



Do not use the device in the rain, or expose it to water.



Keep hands away from the blade during operation.



Do not use the device near a heat source.



Never use this pole within 15m of power lines or electrical wires. Failure to heed this warning may result in serious injury or death by electrocution.

WASTE DISPOSAL



Do not dispose of this device with household refuse. Please adhere to relevant local waste disposal laws and regulations.



This device, accessories and packaging are recyclable.

PRECAUTIONS BEFORE USE

SAFETY INSTRUCTIONS FOR WORK SITES

1. Keep your work area well lit and free from debris.
2. Do not operate the electric secateurs in explosive, flammable or humid environments.
3. Ensure the work area is free of children and other bystanders before operating the secateurs.
4. Before operating the secateur and pole ensure the work site is free of overhead hazards

ELECTRICAL SAFETY INSTRUCTIONS

1. The battery socket of the secateurs must match the battery connector. Do not modify the socket and plug in any way.
2. Do not expose the secateurs to rain or moisture. Water or other liquids entering it may increase the risk of electric shock and damage to the device.
3. Keep the secateurs away from heat, oil, sharp edges or moving parts;
4. Do not use the charger when the power cord or plug is damaged. Damaged and entangled wires can increase the risk of electric shock.

PERSONAL SAFETY INSTRUCTIONS

1. Be alert when operating the secateurs. Do not operate them when fatigued or affected by medication or alcohol. Distraction during operation may cause serious personal injury.
2. Use safety guards and always wear goggles when operating the secateurs. Dust masks, non-slip safety shoes, helmets and hearing protection can help prevent personal injury.
3. Remove all adjustment keys and wrenches before turning on the secateurs. Any wrench or key left on the rotating parts of the secateurs can cause personal injury.
4. When operating, keep your hands away from the work area. Never extend your hands under the material being pruned. Ensure that any material or surface under the operating area is not damaged.
5. Pay attention to your balance in order to better control secateurs in case of accident.
6. Do not wear loose clothes or ornaments and keep long hair, clothes and sleeves away from moving parts.
7. Keep the cutting edge closed when the secateurs are not in use.

TELESCOPIC POLE OPERATION

INSTALLING MSP 3724-2.5

1. Unscrew the cover securing screw.
2. Open the cover-head of the telescopic pole.
3. Insert the connector into the secateurs.
4. Insert secateurs into the head of the telescopic pole.
5. Close the cover-head of the telescopic pole
6. Tighten the cover securing screw.
7. Insert battery into the telescopic pole.

After installation, press power button and double click trigger to open the blade and begin working. When installing or dismantling the secateurs, be sure to power off the tool.

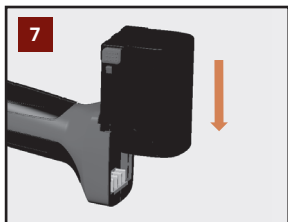
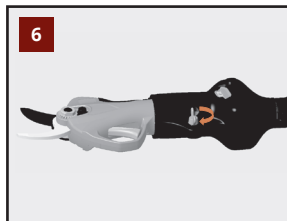
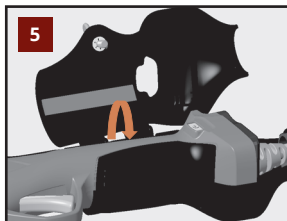
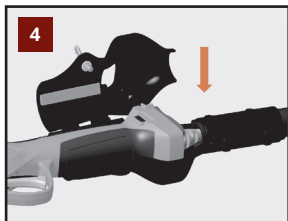
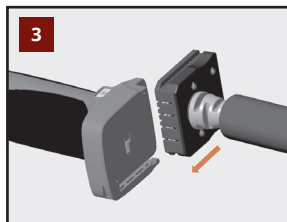
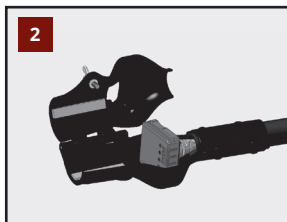

TELESCOPIC POLE LENGTH ADJUSTMENT

1. Press the handle to the end to fix the telescopic pole to the selected length.
2. The length of the telescopic tube can be adjusted by loosening the handle.

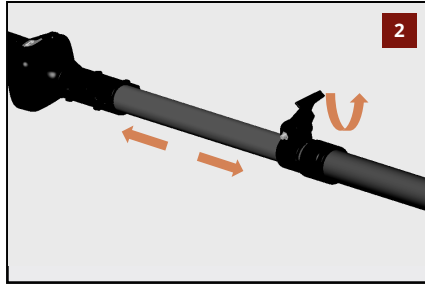
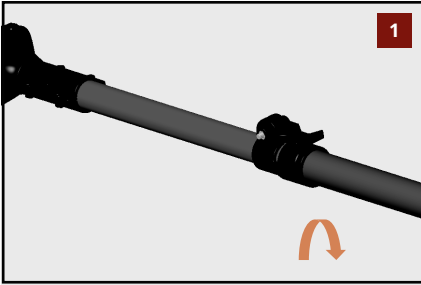

IMPORTANT:
Do not unnecessarily rotate the telescopic pole head as this will shorten the working life of the pole.

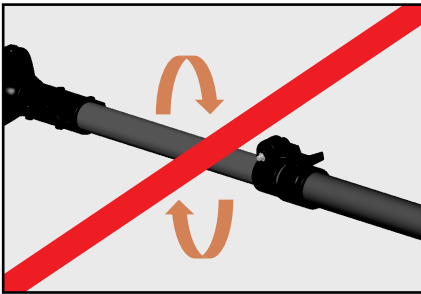

POWER OFF BEFORE
REMOVING BATTERY

PARTS LIST

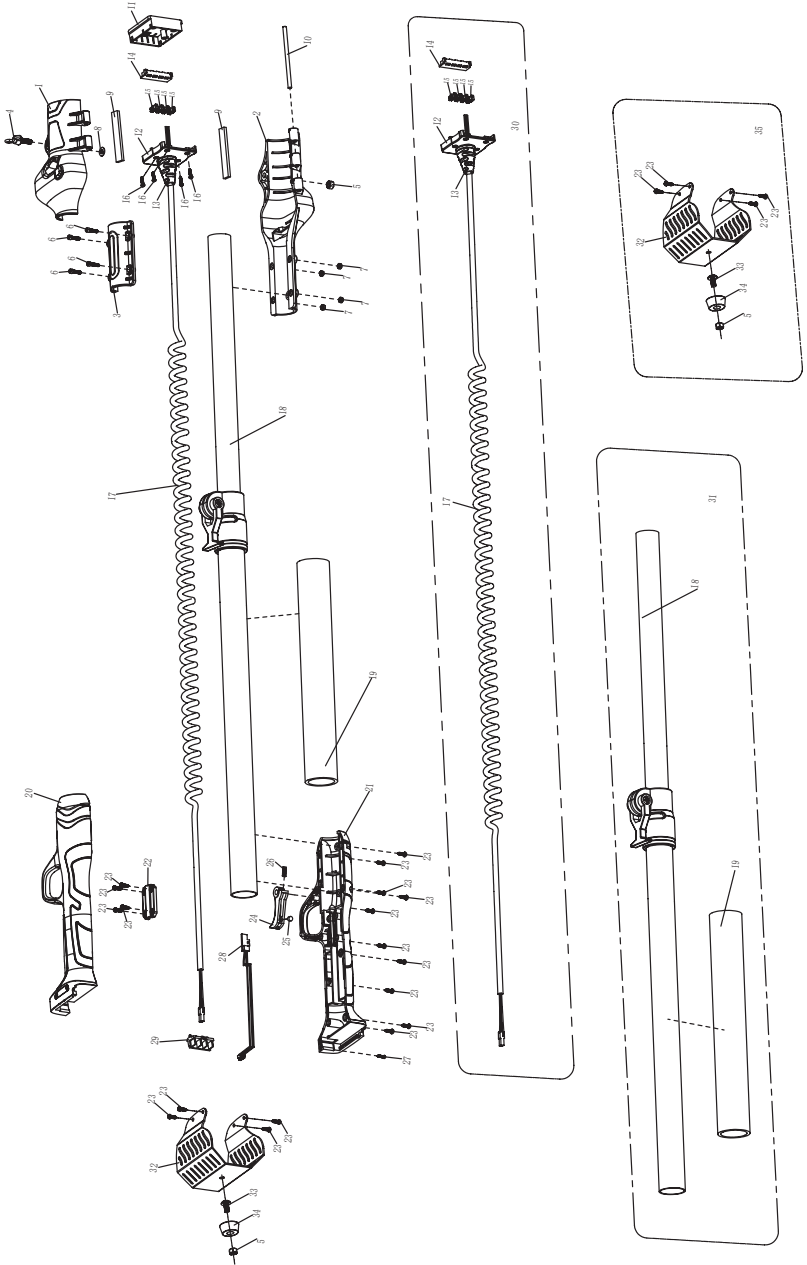

1. Front upper cover
2. Front lower cover
3. Front cover plate
4. M5 x 16mm wing nut
5. M5 x 4.7mm hex nut
6. M3 x 12mm socket head screw
7. M3 hex nut
8. Flat washer
9. EVA foam
10. 4 x 74mm shaft
11. Connector lower cover
12. Connector upper cover
13. SR
14. Side plug shrapnel bracket
15. Battery connector
16. M2.6 x 10mm PA screw
17. Spring wire
18. Extension tube
19. EVA sponge tube
20. Extension pole handle upper cover
21. Extension pole handle lower cover
22. Pressure wire cover
23. M3 x 10mm PA screw
24. Trigger
25. Magnet
26. Spring
27. M2.3 x 10 PA screw
28. Hall panel
29. Side plug connector
30. Wire assembly
31. Extension tube assembly
32. Battery shield
33. M5 x 10m PM screw
34. 22mm x 18mm x 10mm rubber foot mat
35. Battery shield assembly

TECHNICAL DATA

Model Number	MSP 3724-2.5TP
Compatible With	MSP 3724-2.5
Collapsed Size	1.7m
Extended Size	2.4m
Weight	1.4kg

NOTES

NOTES

1339MS 5/22

MOBISHEAR

A U S T R A L I A

100% CORDLESS

Arnd Enneking

M: 0421 062 697 **E:** arnd@mobishear.com.au

Heidi Enneking

M: 0409 289 532 **E:** heidi@mobishear.com.au

Box 89, Mount Barker SA 5251

www.mobishear.com.au

